

INCORRECT MAINTENANCE

Several installed cowling gas springs have been discovered to be incorrectly installed. Maintenance personnel incorrectly installed the gas springs using the shipping hardware, instead of the hardware called out in the AMM. Incorrectly installed gas springs can be identified by inspecting for excessive play / sloppiness in the clevis. If you identify incorrect installed hardware, correct the deficiency immediately by installing the correct hardware called out in the AMM.



- (f) Install the gas spring LH and the gas spring RH of the transmission cowling (2, Figure 803) as follows:

NOTE The procedures to install the gas spring LH and the gas spring RH are the same. The procedure that follows gives the installation procedure of the gas spring LH.

- 1 Clean the screws (4) and the washers (5, 8) with Cleaning Agent CM 203.

300

71-11-00, 8-10 Page 803

2019.01.11

Aircraft Maintenance Manual (AMM) MBB BK117-C2

- 2 Apply Locking Compound CM 683 to the thread of the screws (4). Refer to the instructions of the manufacturer.
- 3 Put the washers (3, 6) and the new gas spring LH (11) in its installation position on the hinge (7) and the bracket (12). Make sure that you install the piston rod (10) of the gas spring LH (11) to the hinge (7).
- 4 Install the washers (5), the screws (4), the washers (8) and the nuts (9).
- 5 Torque the nuts (9).

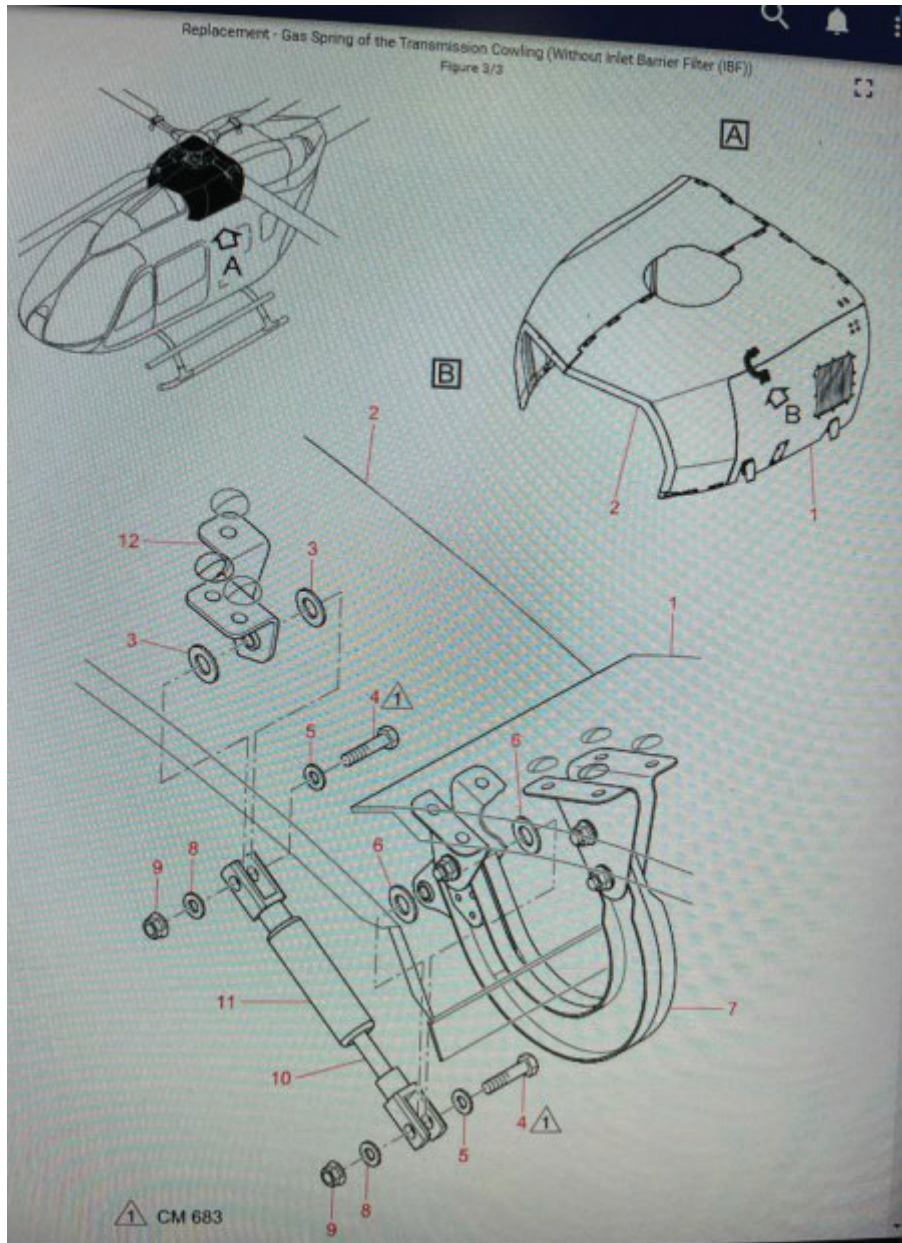

Mr. Gary Graham

Utility Helicopter System Safety Manager

Comm 256-876-4015

DSN 746-4015

Work Cell: 256-975-8487 (Best contact number during teleworking)

gary.a.graham10.civ@Army.mil